

BOBBER SEAT KIT



P/N 2880905

APPLICATION

ALL MY16 INDIAN SCOUT MOTORCYCLES

BEFORE YOU BEGIN

Read these instructions and check to be sure all parts and tools are accounted for. Please retain these installation instructions for future reference and parts ordering information.

KIT CONTENTS

This Kit includes:

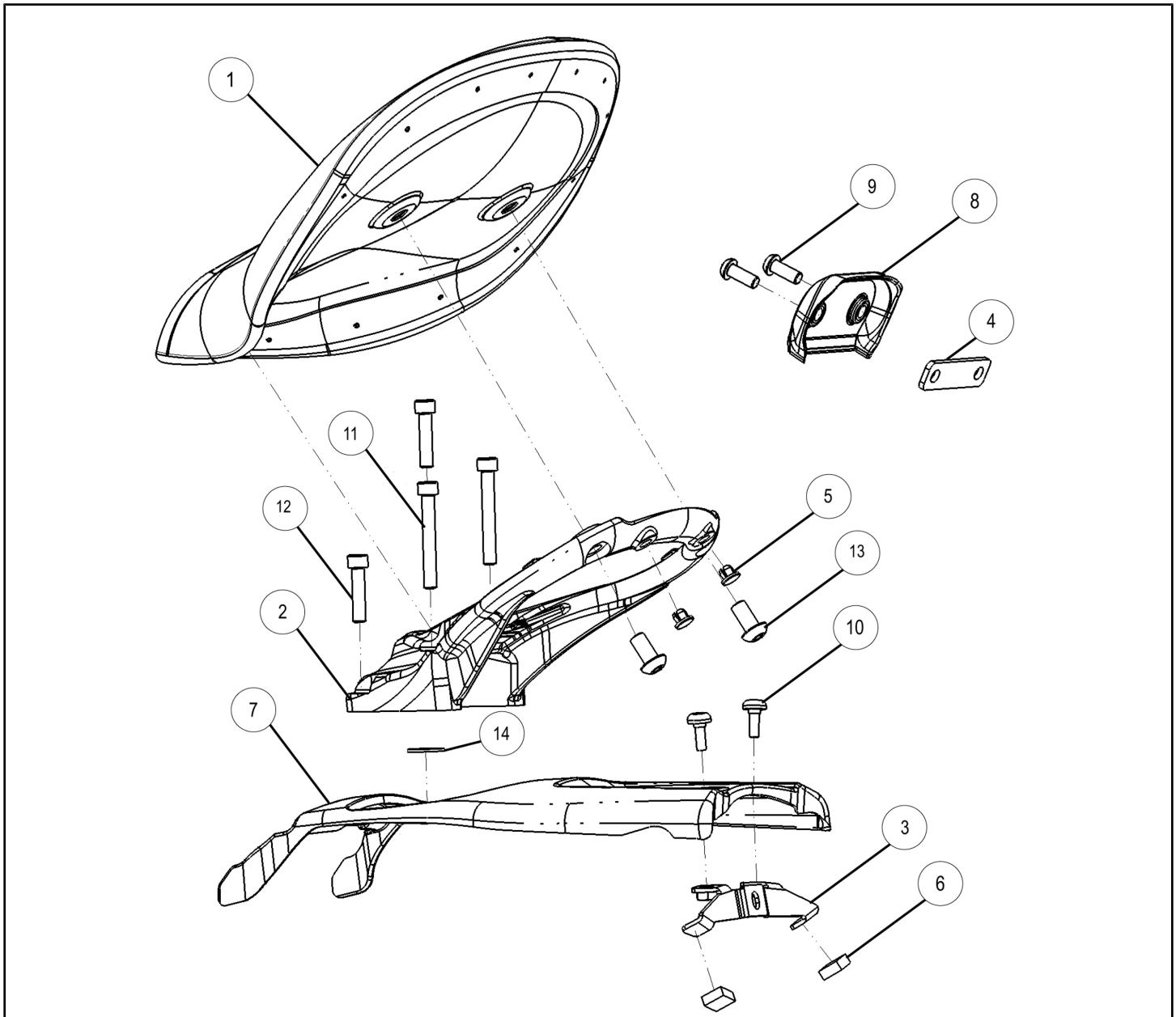

REF	QTY	PART DESCRIPTION	PART NUMBER
1	1	Bobber Seat Assembly	2686486
2	1	Bobber Seat Mount	5140095
3	1	Bobber Seat Panel Bracket	5261221
4	1	Bobber Seat Cover Spacer	5261252
5	2	Plug	5413605
6	2	Rubber Pad	5415109
7	1	Bobber Seat Closeout	5452434
8	1	Bobber Seat Subframe Cover	5452436
9	2	M8 Screw, 1.25 X 20, 5 mm Drive	7517553
10	2	M6 Screw, 1.25 X 20, 6 mm Drive	7520171
11	2	M8 Screw, 1.25 X 60, 6 mm Drive	7520336
12	2	M8 Screw, 1.25 X 35, 6 mm Drive	7520337
13	2	M10 Screw, 1.5 X 20, 6 mm Drive	7520338
14	1	Washer	7556352
	1	Instructions	9925883

TOOLS REQUIRED

- Hex Socket

IMPORTANT

Your Indian BOBBER SEAT KIT is exclusively designed for your vehicle. Please read the installation instructions thoroughly before beginning. Installation is easier if the vehicle is clean and free of debris. For your safety, and to ensure a satisfactory installation, perform all installation steps correctly in the sequence shown.

ASSEMBLY TIME

Approximately 20 minutes

INSTALLATION INSTRUCTIONS

Removal

1. Detach OEM seat. See Owners Manual.
2. Remove lanyard from frame by disconnecting the ground battery terminal from the frame. Replace ground terminal screws without the lanyard or lanyard loop, and torque to following specification.

TORQUE

84 in. lbs. \pm 9 in. lbs. (9.4 Nm \pm 1 Nm)

3. Remove rear fender bolt (B) and top hat (A).

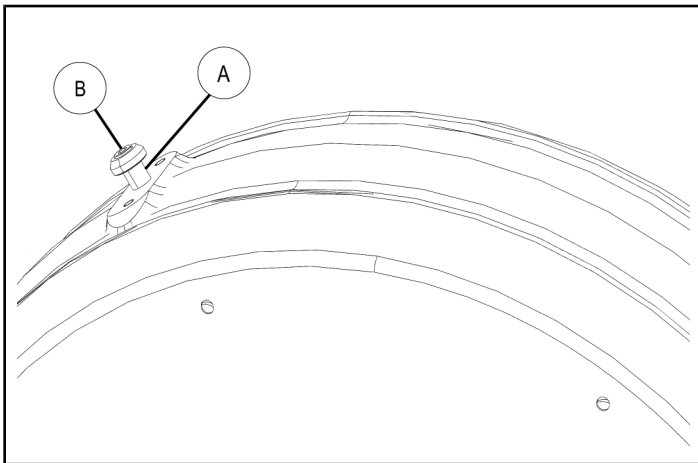

4. Peel back rubber pad (C) and remove all four screws (D).
5. Lift tank slightly and remove rubber pad. Careful to not unplug EVAP lines (E) and (F).

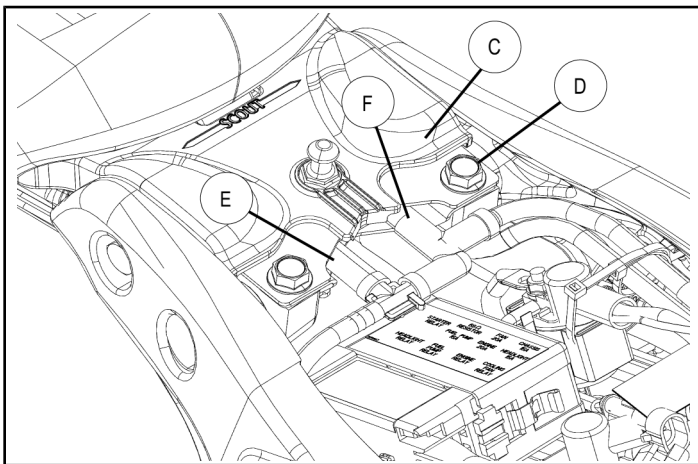

6. Remove seat post screw (G).

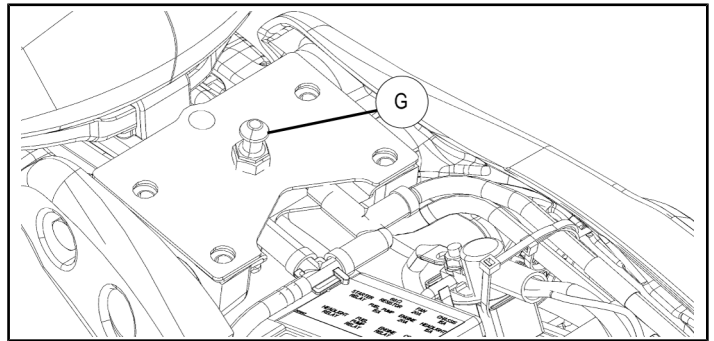

Installation

7. Place closeout mounting bracket ③ in vehicle by wedging down electrical harness as much as possible.

CAUTION

Extra care should be taken when inserting bracket and fastener near the electrical harness. Damage to adjacent wiring could result in loss of ignition or function to safety critical operating components.

Reuse the hex socket head screw (B) from Step 3 to hold the bracket in place as shown. Ensure bracket ③ is placed in vehicle with both rubber pads touching frame. Torque to following specification .

TORQUE

18 ft. lbs. \pm 2 ft. lbs. (24 Nm \pm 3 Nm)

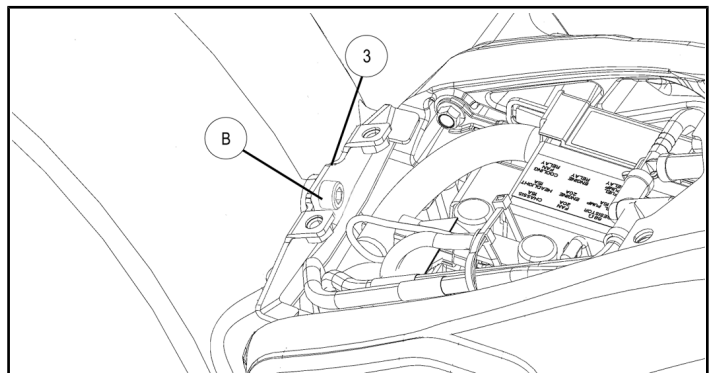

8. Add in closeout ⑦ by lifting tank slightly, sliding in plastic as shown.

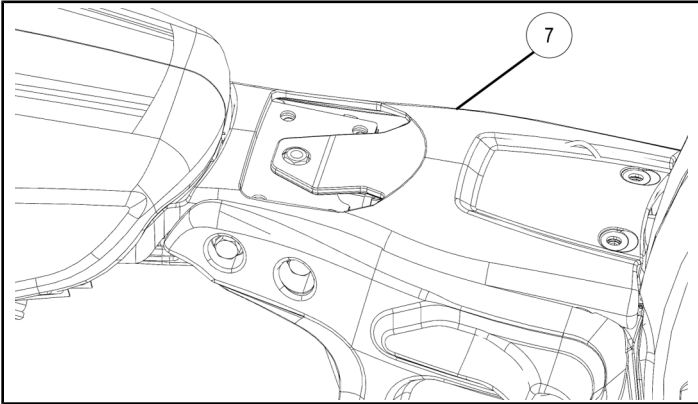

9. Add washer ⑭ then replace front seat post and torque to following specification

TORQUE

18 ft. lbs. ± 2 ft. lbs. (24 Nm ± 3 Nm)

Add screws ⑩ to rear and torque to following specification

TORQUE

96 in. lbs. ± 2 in. lbs. (11 Nm ± 0.22 Nm)

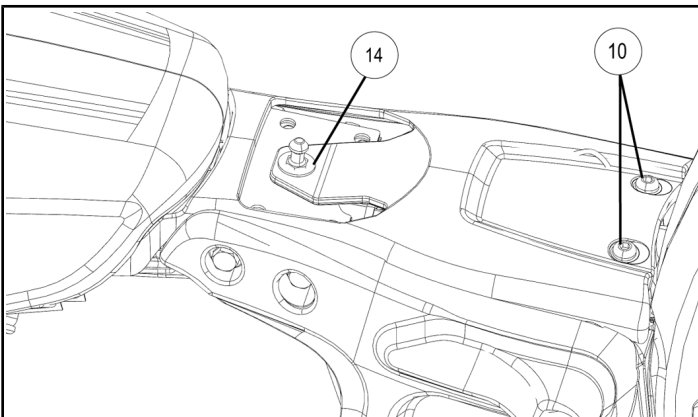

10. Insert mount ② and screws ⑪ and ⑫. Torque each bolt twice in pattern V, W, X, Y. Torque screws to following specification.

TORQUE

18 ft. lbs. ± 2 ft. lbs. (24 Nm ± 3 Nm)

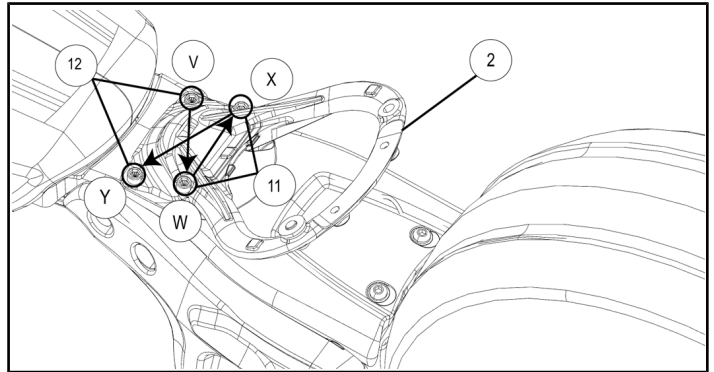

11. Add the two piece assembly, plate ④ and fender cover ⑧ to the rear fender boss. See Image orientation of the fender cover. Torque screws ⑨ to following specification.

TORQUE

18 ft. lbs. ± 2 ft. lbs. (24 Nm ± 3 Nm)

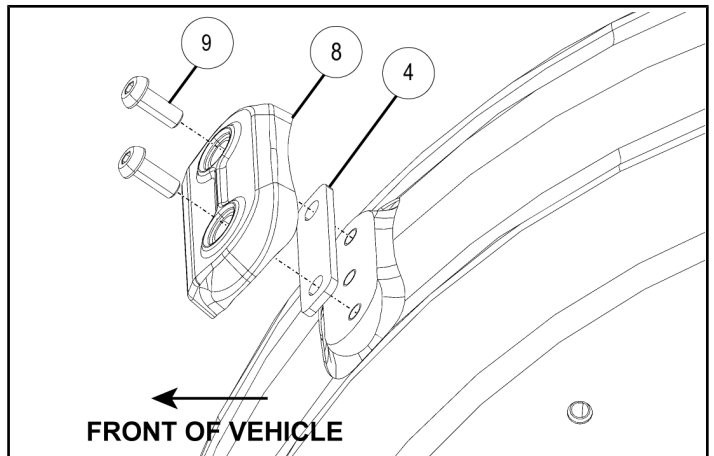

12. Slide bobber seat assembly ① on the mount.
Ensure tongue hooks into bobber mount and
rear seat pan holes align to seat mount.

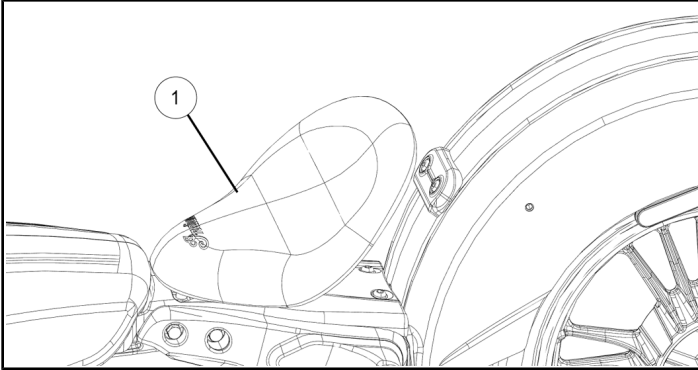

14. Add plugs ⑤ as shown.

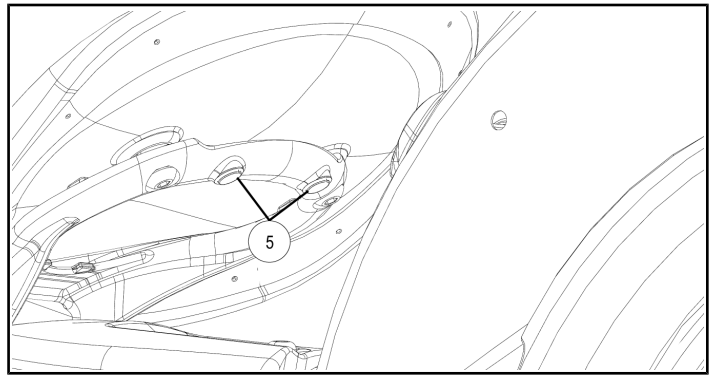

13. Torque M10 bolts ⑬ to following specification.
Ensure seat is locked into place.

TORQUE

18 ft. lbs. \pm 2 ft. lbs. (24 Nm \pm 3 Nm)

